

TYPICAL SECTIONS  
Scale: Horiz. 1" = 5'  
Vert. 1" = 1'

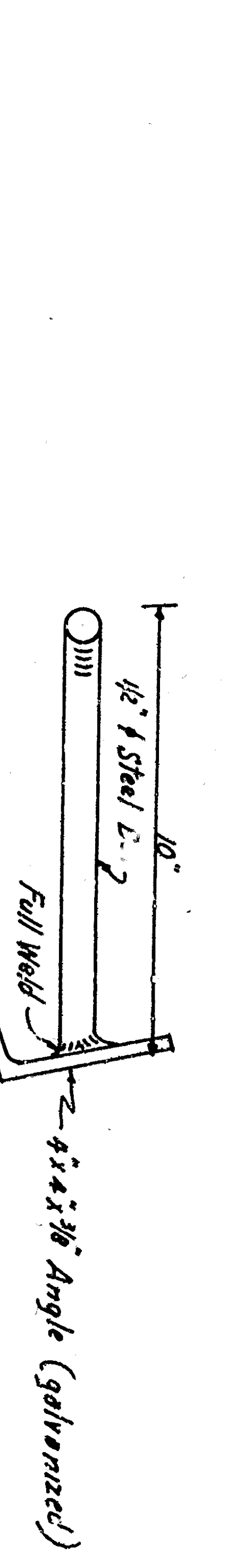

ANCHOR DETAIL

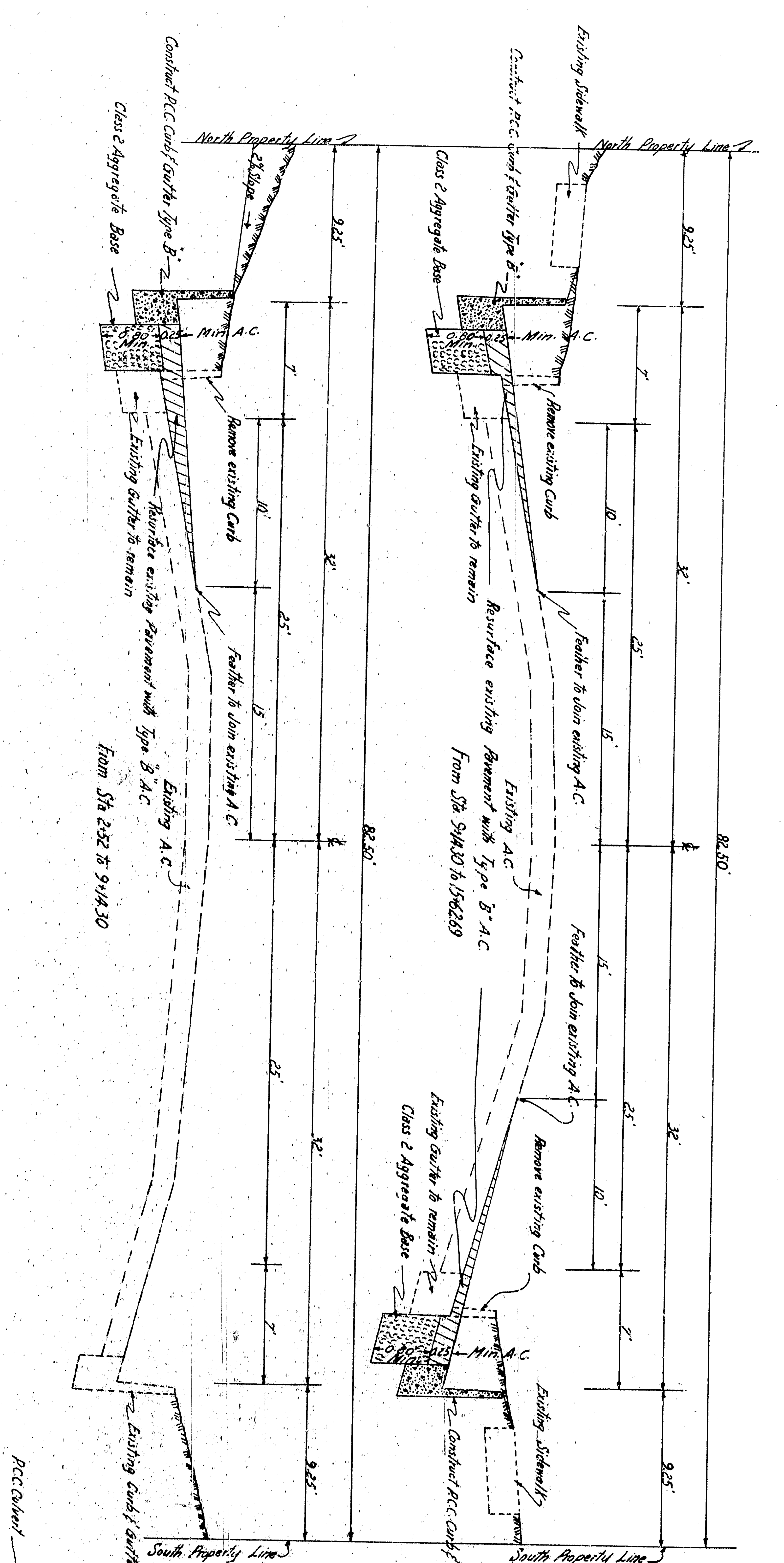
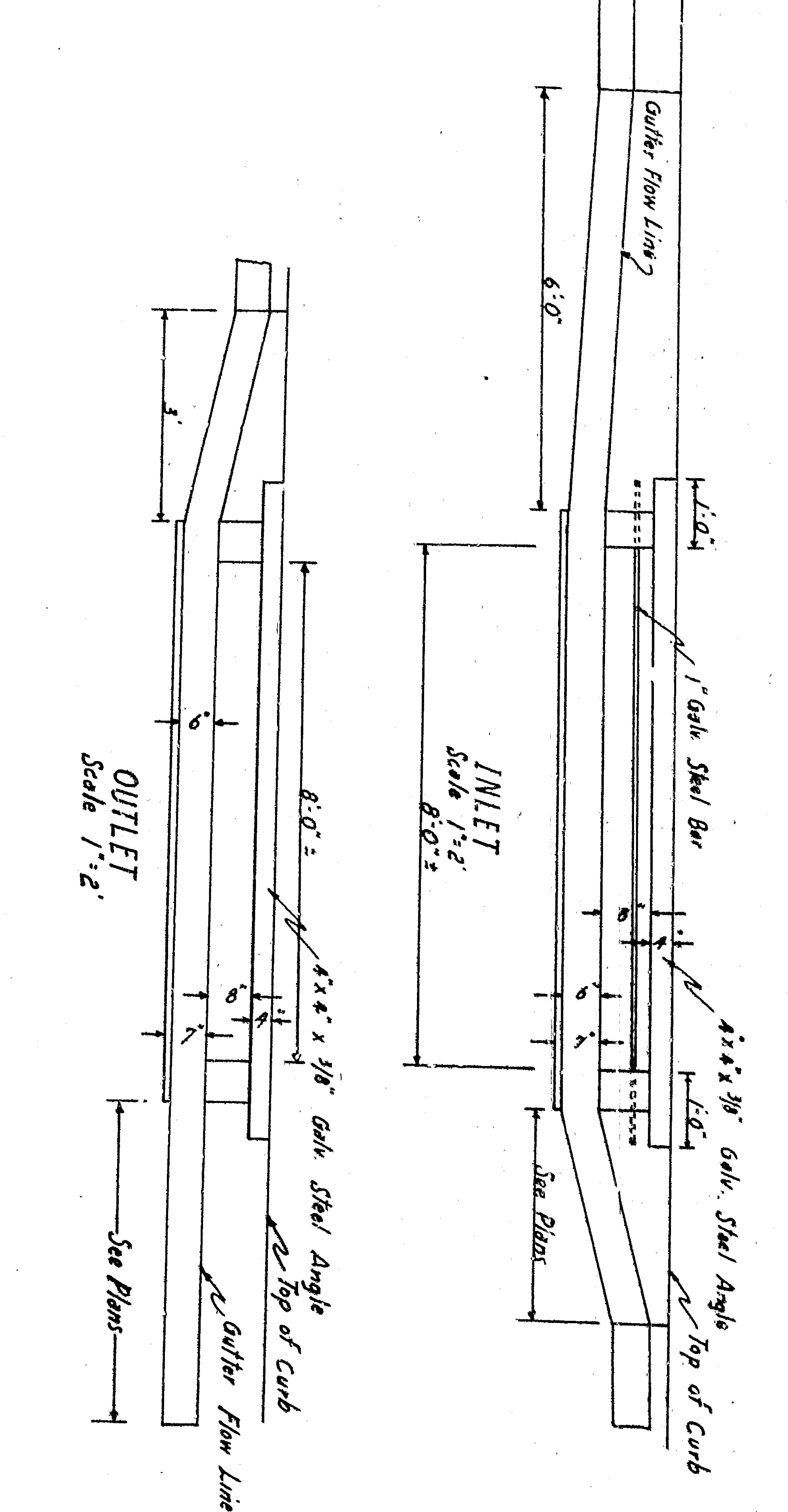

CULVERT-STREET & DRIVEWAY SECTION  
Scale 1" = 2'

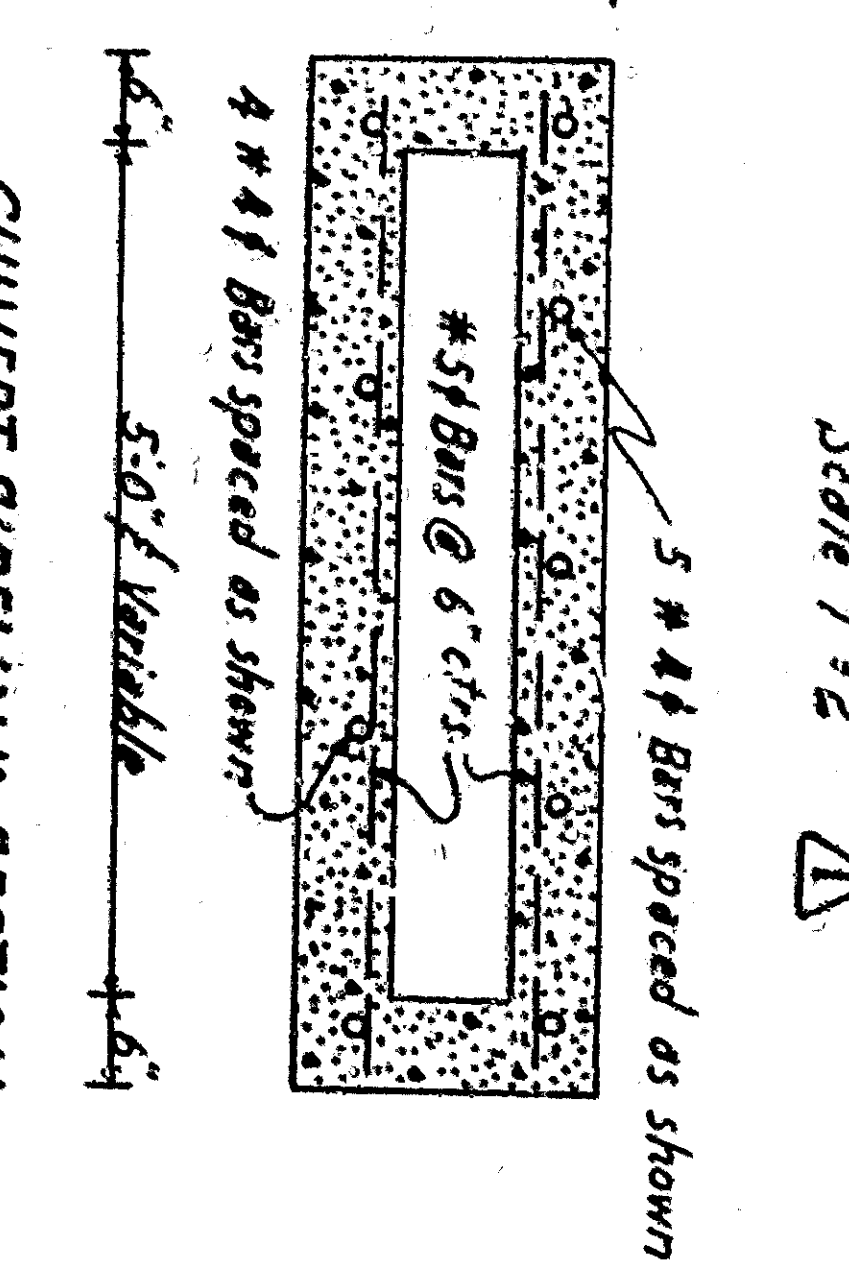

CULVERT-SIDE WALK SECTION  
Scale 1" = 2'

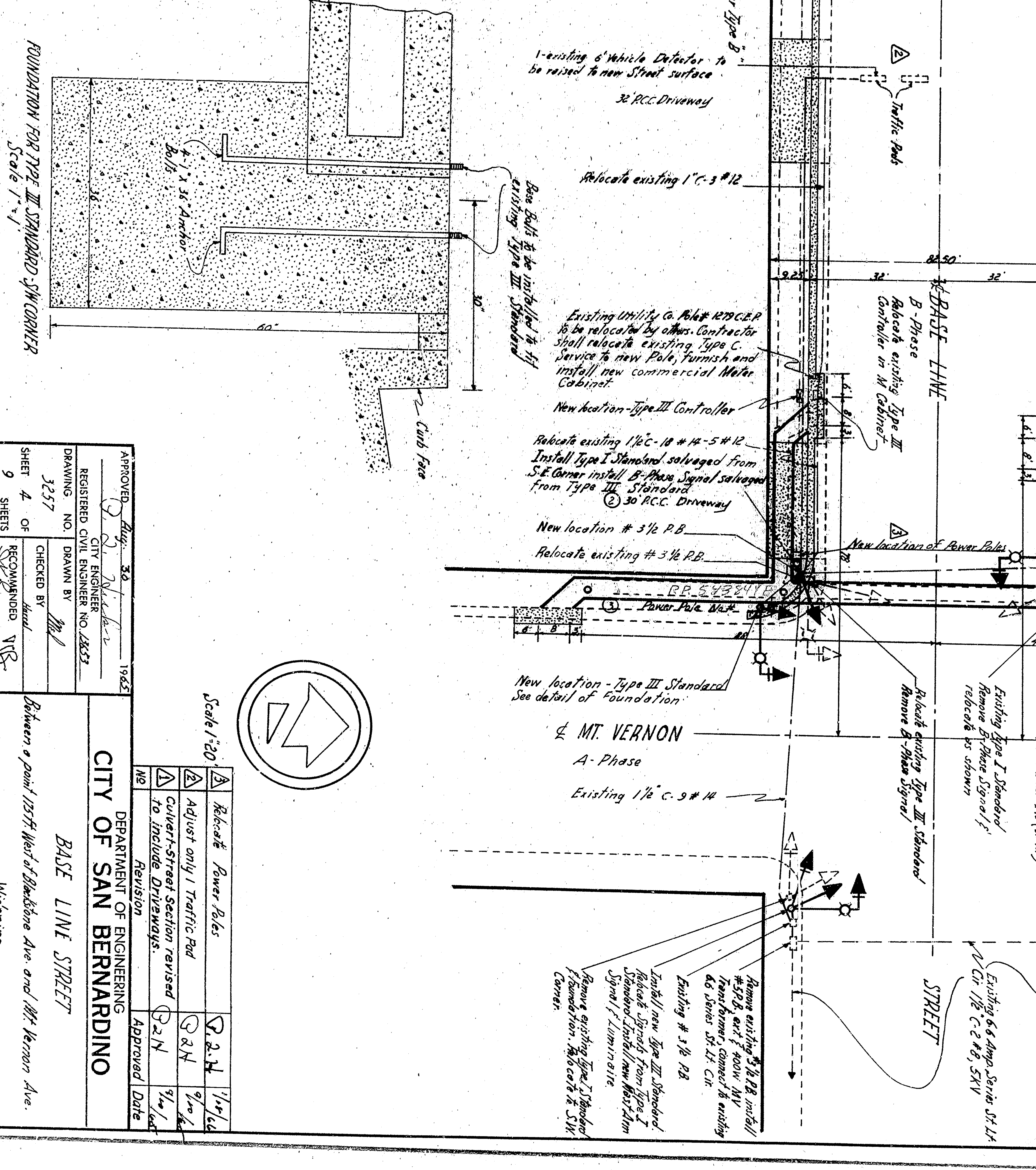

APPROVED: *[Signature]*  
REGISTERED CIVIL ENGINEER NO. 28037  
DRAWING NO. 2237  
SHEET 4 OF 9 SHEETS  
CITY OF SAN BERNARDINO  
DEPARTMENT OF ENGINEERING  
BASE LINE STREET  
Between a point 125 ft West of Stockton Ave and Mt. Vernon Ave.  
Whittier

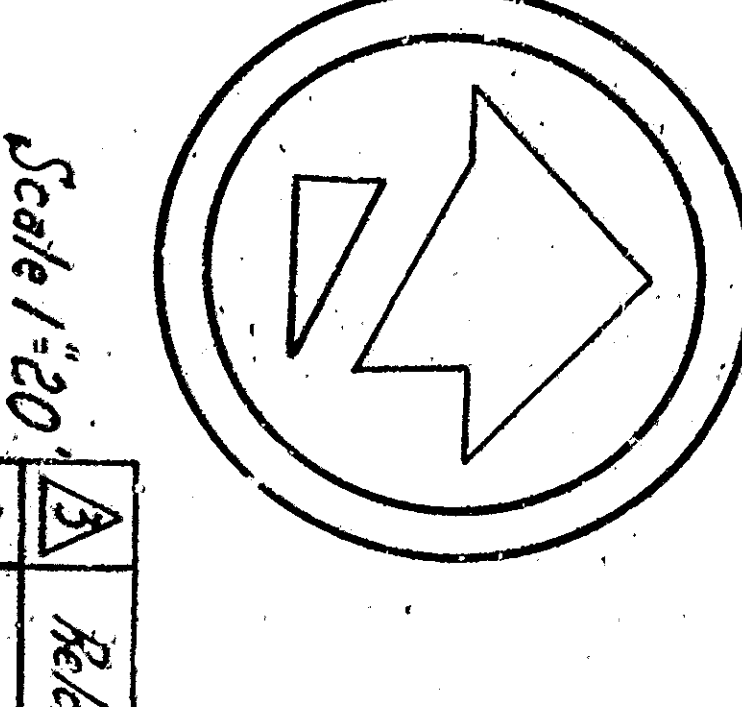

Scale: 1" = 20'

REVISION	DATE
1	1/11/16
2	1/14/16
3	1/14/16